

INSTALLATION GUIDELINE

HEATING/COOLING CEILING | METAL PANEL CEILING WITH CAPILLARY TUBE MATS

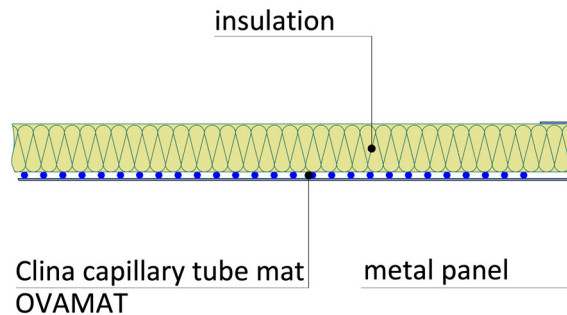

The capillary tube mat is fixed on the inside of the metal panel, usually with glue. The metal panels are inserted in a suspended ceiling grid and equipped with an insulating material. On the visible side you get a perforated or unperforated metal panel grid ceiling for the removal or supply of sensitive heat loads to a large extent via radiation, partly by convection.



Dry construction

Plant engineering

1. installation of the substructure/grid system (rail system) according to the ceiling type, panel dimensions and the manufacturer's instructions
2. installation of the piping or supply lines for the Clina capillary tube mats in the ceiling void
3. gluing capillary tube mats into the metal panels
 - apply adhesive to the back of the capillary tube mat using a roller
 - insert mats and press on using a clean roller
 - place insulation on top
 - smaller openings (e.g. for cables) can be made by simply pulling the capillaries apart up to a diameter of approx. 100 mm
4. hooking in or inserting the metal panels
5. connection of the capillary tube mats (metal panels) to each other as well as connection to the supply and return lines/ceiling sub-distributors is made using a push-lock system with flexible hoses
6. filling and leak test
 - leak test using compressed air at 3 bar
 - filling the system with system medium and leak test according to **Clina guideline CR02** "Filling, venting and leak test" at 10 bar
 - fill out test report
 - during further work the system remains under the test pressure of 10 bar
7. closing of the ceiling